

SPECIFICATIONS

Current Rating: 3.0A AC,DC
 Voltage Rating: 100V AC,DC
 Withstanding Voltage: 1000V AC For One Minute
 Temperature Range: -40°C ~ +105°C
 Contact Resistance: 10 Milliohms Max.
 Insulation Resistance: 5000 Megohms Min.
 Insulator: High Temp. Plastic (UL 94V-0)
 Contact: Beryllium Copper
 Selective Gold Plated

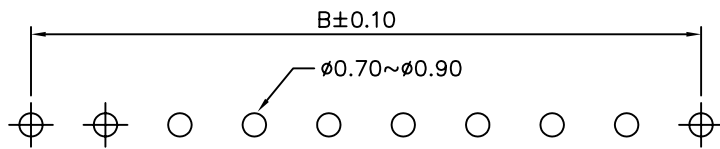

P.C.B. Layout

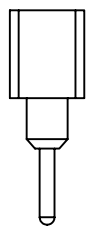
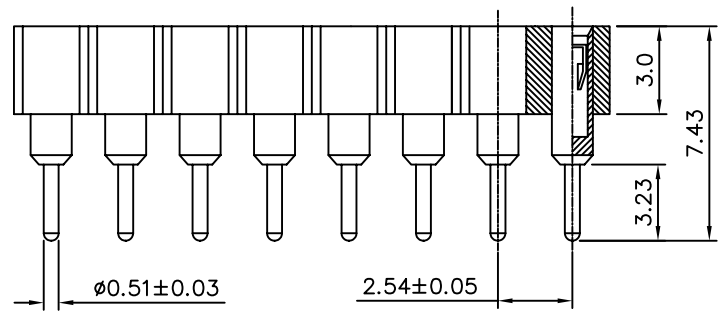
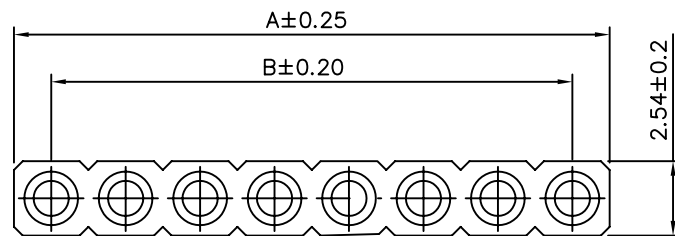

Pos.	A	B	Pos.	A	B
01	2.54	--	21	53.34	50.80
02	5.08	2.54	22	55.88	53.34
03	7.62	5.08	23	58.42	55.88
04	10.16	7.62	24	60.96	58.42
05	12.70	10.16	25	63.50	60.96
06	15.24	12.70	26	66.04	63.50
07	17.78	15.24	27	68.58	66.04
08	20.32	17.78	28	71.12	68.58
09	22.86	20.32	29	73.66	71.12
10	25.40	22.86	30	76.20	73.66
11	27.94	25.40	31	78.74	76.20
12	30.48	27.94	32	81.28	78.74
13	33.02	30.48	33	83.82	81.28
14	35.56	33.02	34	86.36	83.82
15	38.10	35.56	35	88.90	86.36
16	40.64	38.10	36	91.44	88.90
17	43.18	40.64	37	93.98	91.44
18	45.72	43.18	38	96.52	93.98
19	48.26	45.72	39	99.06	96.52
20	50.80	48.26	40	101.60	99.06

4UCON 元化興業股份有限公司
 4UCON TECHNOLOGY INC.

DRAWING No.		APPROVED BY		UNLESS OTHERWISE SPECIFIED TOLERANCES ARE .X ±0.25 .XX ±0.20 ANG.					
05954		MEI							
		CHECKED BY							
		BECKY							
		DRAWING BY							
		HZF							
SCALE	NONE	REV.	BO	UNIT	mm	△ BO	NEW RELEASE	BECKY	02/15/2006
						NO.REV.	REVISIONS	CHK	DATE